



TWEETER

T25-001

E 006

| | | | |
|------------------------------------|--------------|------------------------------------|-----------|
| NOMINAL IMPEDANCE | 6 Ohms | VOICE COIL RESISTANCE | 4,3 Ohms |
| RECOMMENDED FREQUENCY RANGE | 2000-25000Hz | VOICE COIL INDUCTANCE (EQUIVALENT) | 0,05 mH |
| SHORT TERM MAXIMUM POWER* | 200 W | VOICE COIL DIAMETER | 26 mm |
| LONG TERM MAXIMUM POWER* | 90 W | VOICE COIL HEIGHT | 1,5 mm |
| CHARACTERISTIC SENSITIVITY (1W,1m) | 90 dB SPL | MOVING MASS | 0,33 g |
| OPERATING POWER (96 dB SPL, 1m) | 4,0 W | EFFECTIVE PISTON AREA | 7,0 sq.cm |
| AIR GAP HEIGHT | 2,0 mm | LINEAR COIL TRAVEL (p-p) | 0,5 mm |
| MAGNETIC GAP FLUX DENSITY | 1,8 T | FREE AIR RESONANCE | 750 Hz |
| FORCE FACTOR | 3,5 N/A | | |
| MAGNET WEIGHT | 0,34 Kg | | |
| TOTAL WEIGHT | 0,80 Kg | | |

* IEC 268-5, VIA HIGH PASS BUTTERWORTH FILTER: 2500 Hz 12 dB/oct.

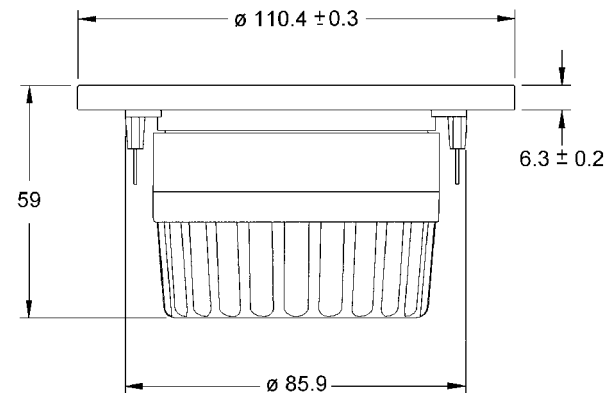
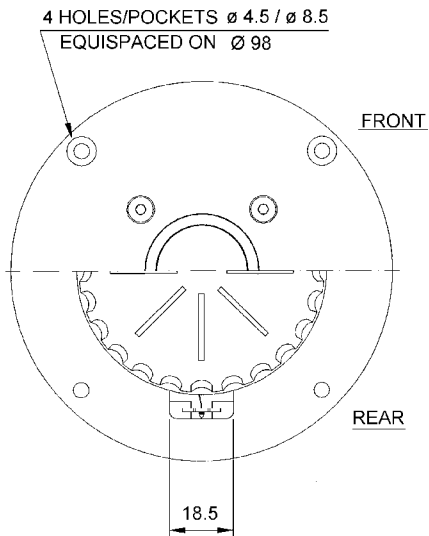

The T25-001 is a 25mm fabric dome with moderately high efficiency. It is the tweeter of choice for those who want the most precise and realistic reproduction of the high frequency audio range.

SPECIAL FEATURES

An optimally shaped diaphragm which gives well-controlled behaviour through the entire high frequency band. This diaphragm is produced from SONOTEX, a proprietary material developed and manufactured only by SEAS. The SONOTEX process pre-coats the fabric 4 times with a damping/sealing material, resulting in excellent acoustic performance and consistency.

Silver voice coil which improves electrical conductance for greater sensitivity to the fine details in the music signal.

Flexible lead-out wires which ensure a good connection between voice coil and terminals. This arrangement also helps to prevent lead breakage due to the large excursions encountered when low crossover frequencies are used.

Low viscosity magnetic fluid which provides excellent cooling while maintaining a low resonance frequency.

6 mm solid metal front plate with a slight loading characteristic which ensures linear frequency response, and a stiff and stable connection to the cabinet.

A substantial injection-moulded rear chamber, with complex internal shape and reinforcing ribs, which eliminate unwanted chamber resonances and reflections.

A double magnet system which increases sensitivity and provides better control of the voice coil. This system also reduces the magnetic stray fields, making the T25-001 an ideal choice in high end A/V applications.

Response curve recorded in an anechoic chamber (Free-field, 4 pi radiation) with 0.5m microphone distance. The loudspeaker is mounted in a 0.6m by 0.8m baffle.

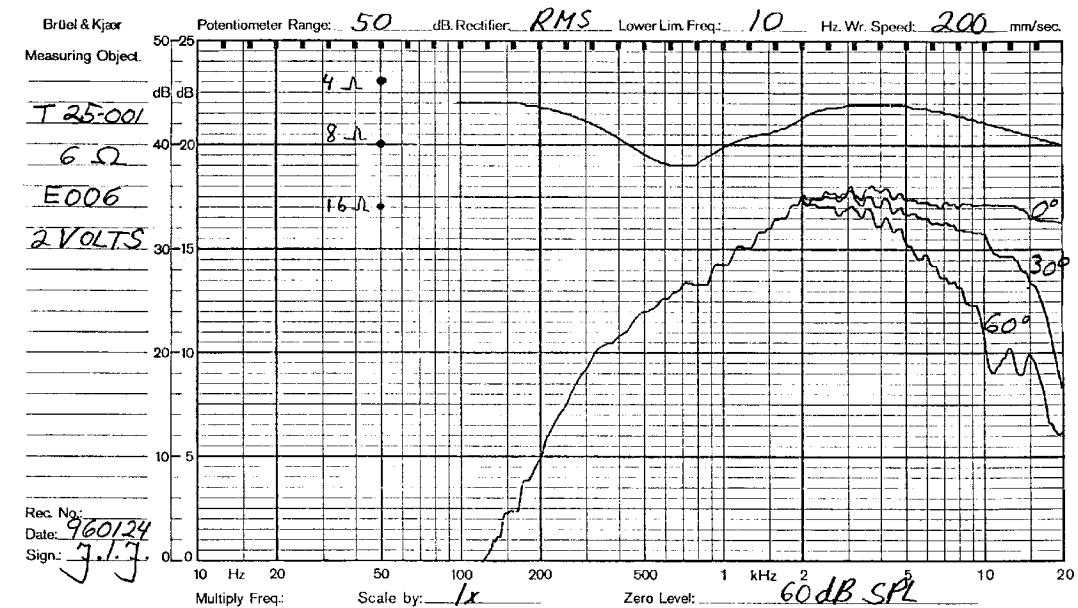

Cumulative spectral decay

